

MOTOR MOUNT

PREVIOUS SYSTEM

Bigger dimensions

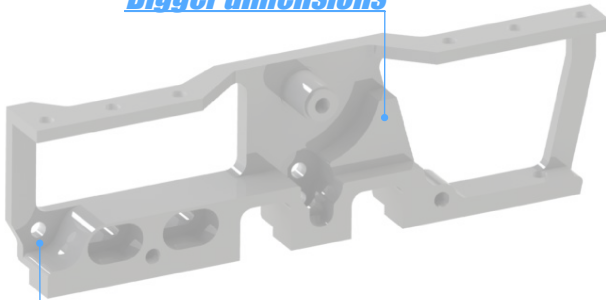

Only one fixed bearing position

Compact design



Adjustable belt tensioner

The motor mount is more compact and has two positions to mount an additional belt tensioner bearing, to allow fine tuning of belt tension.

STEERING SYSTEM

PREVIOUS SYSTEM

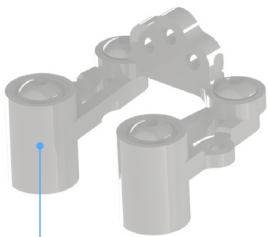

Double bellcrank steering

New steering plate

A new single bellcrank steering is fitted directly to the low profile servo mount, reducing play to a minimum and providing maximum precision when driving the car. It has two steering rod positions (short/long).

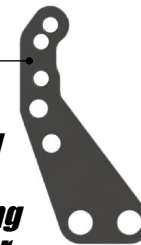

PREVIOUS SYSTEM

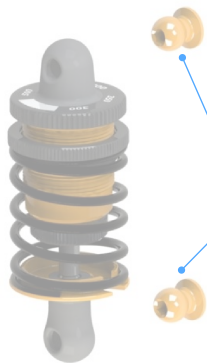

5mm ball with 2mm HEX.

6mm diameter balls with 2.5mm hex, improving reliability. A new silicone X-ring reduces friction of the shock absorber shaft.

New X-ring included



6mm ball with 2.5mm hex.

OTHER NEW PARTS

Hard upper arm optional (A2148-H)



Turnbuckle/camber wrench optional (B0557)



included

New composite parts made from extremely hard material:

- Front bumper plate
- Body height adjuster
- Body stopper
- Lower arm damper mount

