

<b>DRIVER</b>	Kit Std. Setup JP Asphalt		
<b>DATE</b>			
<b>TRACK</b>	Carpet <input type="radio"/>	Asphalt <input checked="" type="radio"/>	
<b>TRACTION</b>	<input type="radio"/> LOW	<input checked="" type="radio"/> MEDIUM	<input type="radio"/> HIGH
<b>LAYOUT</b>	<input type="radio"/> SLOW	<input checked="" type="radio"/> MIXED	<input type="radio"/> FAST
<b>TEMP °C</b>	<b>AIR</b>	<b>TRACK</b>	
<b>ELECTRONICS</b>			
ESC	ESC SET	MOTOR	
SERVO	RECEIVER	BATTERY	
<b>TIRES</b>			
<b>BRAND</b>	Rush/Yurugix		
<b>TYPE</b>	36S/40S		
<b>ADDITIVE</b>	NASA V3 Yellow		
<b>WARMER °C</b>	FRONT 60°	REAR	60°
<b>TIME(min)</b>	FRONT 7min	REAR	7min
<b>SHOCK ABSORBERS</b>			
<b>PISTON</b>	FRONT Std.	REAR	Std.
<b>SHOCK CASE</b>	Std.		Std.
<b>OIL</b>	400	400	
<b>SPRING</b>	6.75	6.5	
<b>LENGTH</b>	9.5		9.5
<b>ANTI ROLL BAR DIAMETER FRONT/REAR</b>			
<b>FRONT</b>	1.1	<b>REAR</b>	1.1
<b>REAR DIFFERENTIAL</b>			
<b>DIFF OIL CST (1,6g oil qty.)</b>	6.000		
<b>GEAR RATIO</b> (T)Spur/(T)Pinion*1,9=Ratio			
<b>PINION</b>		<b>SPUR</b>	
<b>AERODYNAMIC SETTINGS</b>			
<b>BODY TYPE</b>	Twister		
<b>WING TYPE</b>	Std.		
<b>WING POS</b>	(mm)		
<b>BODY POSITION</b> (see picture below)	(mm) horizontal 54		
<b>FRONT BODY HEIGHT &amp; POSITION</b>	<b>REAR BODY POST A2407C</b> <input type="radio"/>	<b>REAR BODY POST A2416B</b> <input checked="" type="radio"/>	
(mm) vertical	51,5	(mm)	44,9

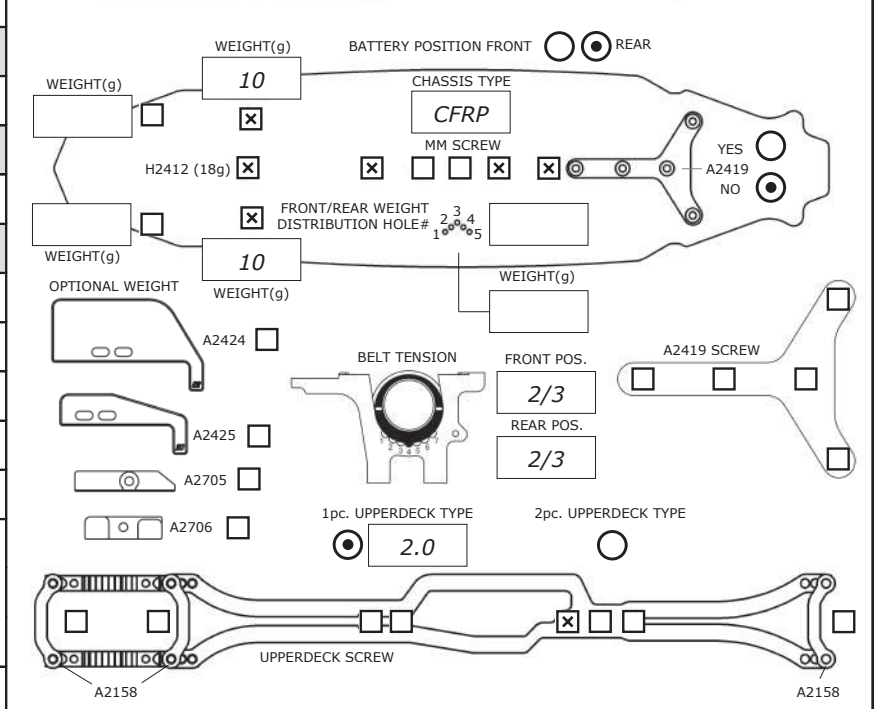
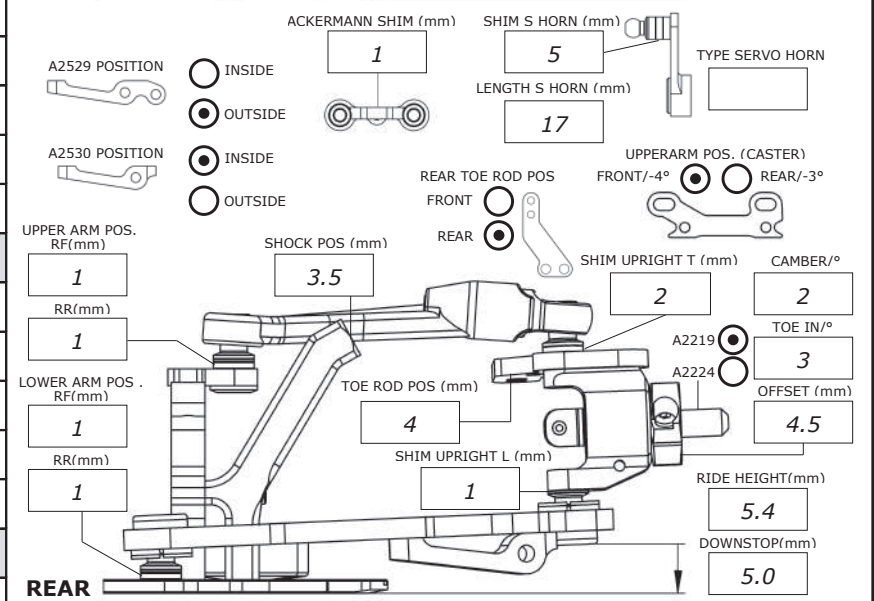
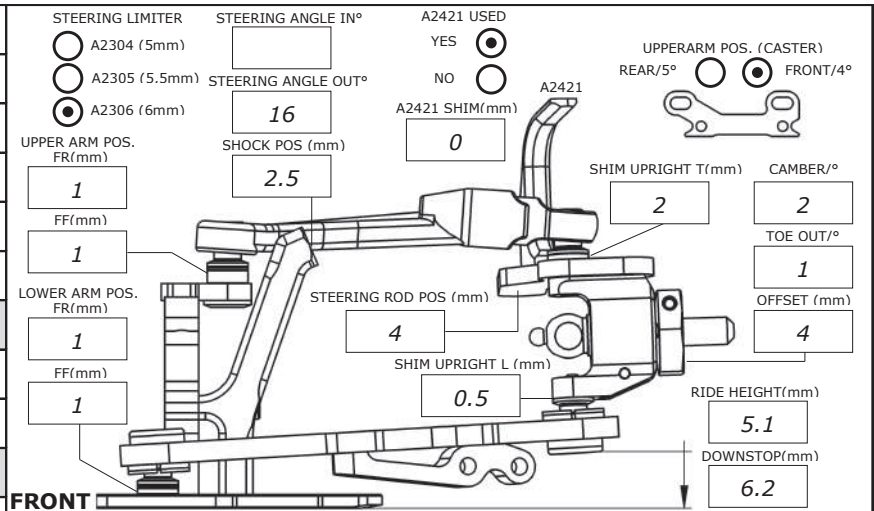

**REMARKS**  
 -In case of using the horizontal rear body post A2407C, the distance from wing mount to the center on body hole is 48mm!