

Name: _____
 Date: _____
 Track: _____

Track conditions
 Size: Open Med. Tight
 Traction: High Med. Low
 Surface: Smooth Med. Bumpy

Result
 Race time / Lap: _____
 Best lap (1Lap): _____

Front suspension

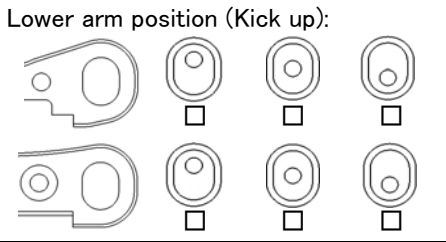
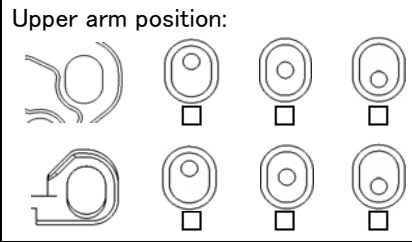
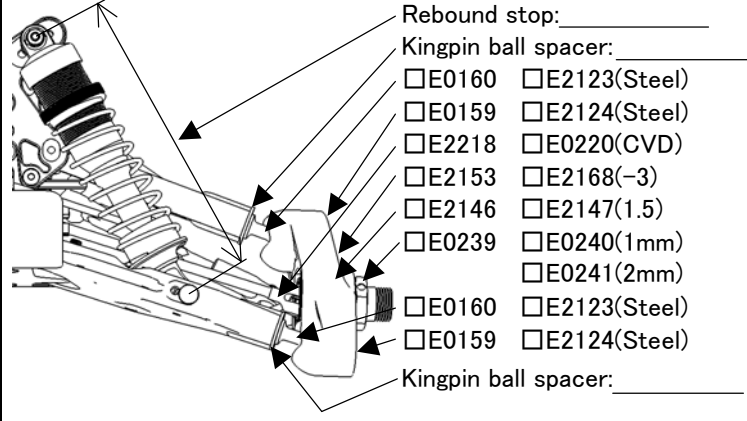

Rebound stop: _____
 Kingpin ball spacer: _____
E0160 E2123(Steel)
E0159 E2124(Steel)
E2218 E0220(CVD)
E2153 E2168(-3)
E2146 E2147(1.5)
E0239 E0240(1mm)
E0241(2mm)
E0160 E2123(Steel)
E0159 E2124(Steel)
 Kingpin ball spacer: _____

Ride height: _____
 Toe angle: _____
 Lower arm plate: _____
E2144A,B
E2154(CFRP 1mm)
E2155(CFRP 1.2mm)
 Anti roll bar: _____
 Upper arm spacer: _____

Lower arm spacer: _____

Front shocks

Piston: _____ Oil: _____
 Spring: _____
 Shock position: _____

 Pivot ball position: Front Rear
 Damper stay: E2562(Aluminum)
E2565(CFRP)

Steering ackerman

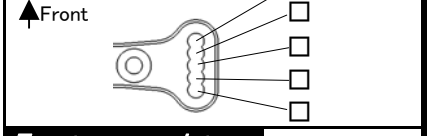

Front upper plate

E2148D E2158(CFRP)
Servo saver arm
E2301A E2310(Aluminum)

Rear suspension

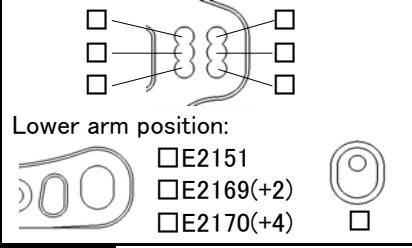
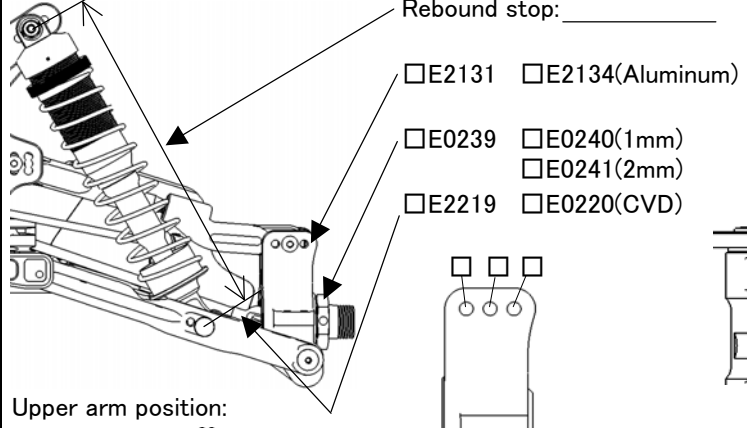

Rebound stop: _____
E2131 E2134(Aluminum)
E0239 E0240(1mm)
E0241(2mm)
E2219 E0220(CVD)

Ride height: _____
 Camber angle: _____
 Lower arm plate: _____
E2145A,B
E2156(CFRP 1mm)
E2157(CFRP 1.2mm)
 Anti roll bar: _____
 Lower arm spacer: _____

Upright spacer: _____

Lower arm position:

Rear shocks

Piston: _____ Oil: _____
 Spring: _____
 Shock position: _____

 Pivot ball position: Front Rear
 Damper stay: E2563(Aluminum)
E2566(CFRP)

Center shaft

E2228,E2229
E0223,E0259(CVD) E2261,E2262

Tension rod

Front: E2107A(Long) E2107B(Short)
 Rear: E2148C E0803(Rubber)

Weight



Engine

Type: _____ Plug: _____ Reducer: _____
 Muffler: _____ Fuel: _____ Gasket: _____
 Engine mount: E0701(Standard) E2713(One piece)

Diff. gear

Oil _____
 Front: 44/13T 42/12T
 Rear: 44/13T 42/12T
 Center: 44T 45T 46T
47T 48T

Tires

Front Type: _____ Compound: _____ Inserts: _____ Wheel: _____
Rear Type: _____ Compound: _____ Inserts: _____ Wheel: _____

Clutch

Clutch bell:		<input type="checkbox"/> 13T	<input type="checkbox"/> 14T			
		φ 0.9	φ 0.95	φ 1.0	φ 1.05	φ 1.1
A	<input type="checkbox"/> C0754 <input type="checkbox"/> E0704 <input type="checkbox"/> E0710					
B	<input type="checkbox"/> C0754 <input type="checkbox"/> E0704 <input type="checkbox"/> E0710					
C	<input type="checkbox"/> C0754 <input type="checkbox"/> E0704 <input type="checkbox"/> E0710					

Body/Wing

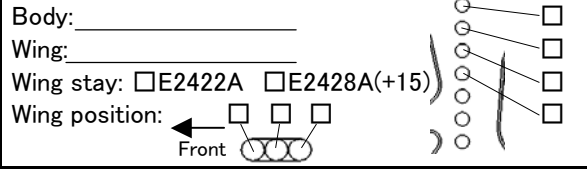

Comments

.....

